

Update as of September 2025

New Ontario Campus

4012 and 4016 East Ontario Ranch Road, Ontario, CA 91761

PROJECT DETAILS

Designed: In Progress

Master Plan Architect: DLR

Estimated Cost: \$201.2M

Criteria Architect: LPA Architects

PHASE 1

- **Welcome Center and Cybrary:** 40,000 GSF; 3 stories
- **Instructional and Student Support Building:** 25,100 GSF; 2 stories
- **PV Solar Shade Structure:** 33,000 GSF
- **Sitework and Infrastructure:** drives, parking lots, utilities, green spaces, etc.

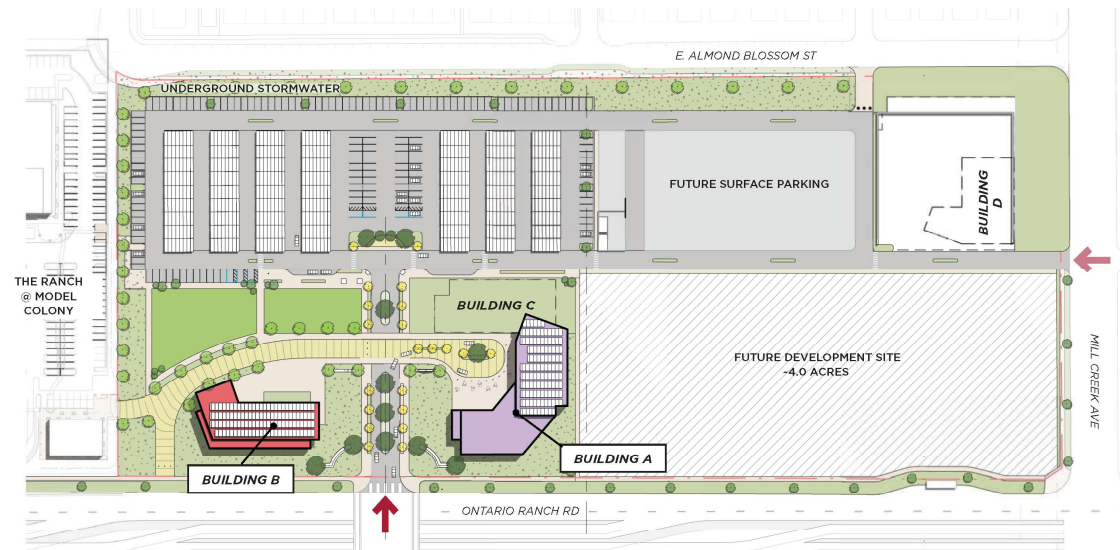

PROJECT UPDATES

- Design-Build Criteria Architect in process with Stakeholder/User Group engagement for establishing design criteria for campus development



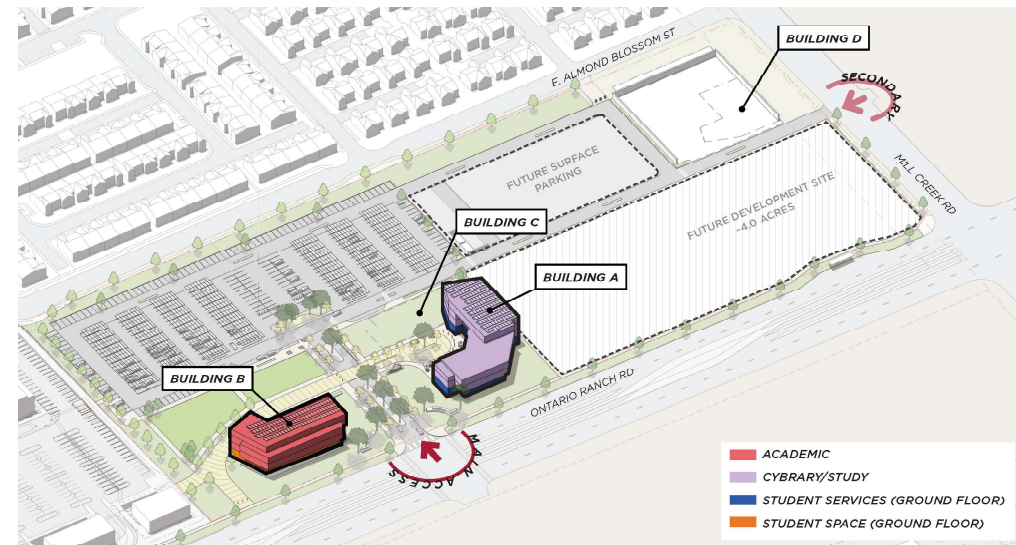

PLANNED ACADEMIC PROGRAMS

Building A (3-Story) Welcome Center Program space categories to include: Cybrary, University Center, Administrative Offices, Meeting Spaces, Campus Police, Health Services, Recreation/Student Space, Campus Store, Student Services

Building B (2-Story) Academic Building Program space categories include: Instructional Spaces for Tech Programs (Engineering, Megatronis, Robotics, Industrial Electrical Technology, etc.), Faculty Offices and Support

